

Flat Steel System

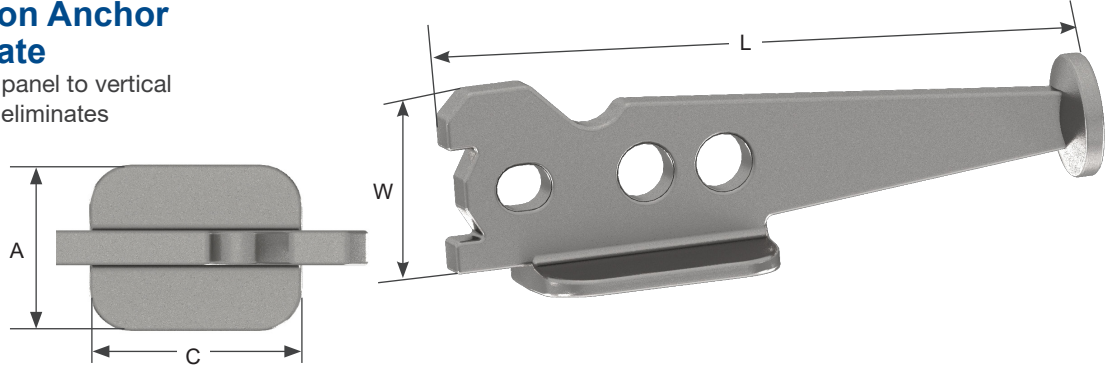

Forged Erection Anchor With Shear Plate

Designed to edge lift panel to vertical position. Shear plate eliminates need for shear bars.



TON	SYS CODE	RING CLUTCH	ITEM CODE	BODY LENGTH (L)	BODY WIDTH (W)	BODY THICK. (T)	PLATE WIDTH (A)	PLATE LENGTH (C)	SWL TENSION (LBS)	UML (LBS)
3	2.5T	2-3 T	CNFEA3TS	8"	2-3/8"	3/8"	2-1/2"	3-1/2"	6000	24000
6	5.0T	4-6 T	CNFEA6TS	10-1/2"	2-7/8"	5/8"	3"	4"	12000	48000
12	10T	12 T	CNFEA12TS	12-13/16"	4-5/16"	3/4"	3-1/4"	4"	24000	96000

UML=Ultimate Mechanical Load
 Safe working loads based on approximate 4:1 Safety Factor in 3,500 psi normal weight concrete.

TON	SYSTEM CODE	ITEM CODE	PANEL THICKNESS	SWL SHEAR W/SHEAR PLATE (LBS)	SWL TENSION W/O TENSION BAR (LBS)	SWL TENSION W/TENSION BAR (LBS)
2-3 Ton Ring Clutch						
3	2.5T	CNFEA3TS	4"	1800	6000	6000
			5"	2300		
			6"	2800		
			7"	3400		
			8"	4000		
			9"	4400		
			10"	4800		
			11"	5200		
12"	5700					
4-6 Ton Ring Clutch						
6	5.0T	CNFEA6TS	5-1/2"	3100	10000	12000
			6"	3250		
			7"	3700		
			8"	4040		
			9"	4600		
			10"	5000		
			11"	5500		
			12"	6100		
12 Ton Ring Clutch						
12	10T	CNFEA12TS	7-1/2"	4600	17890	24000
			8"	4800		
			9"	5450		
			10"	6100		
			11"	6800		
			12"	7600		

Safe working loads based on approximate 4:1 Safety Factor in 3,500 psi normal weight concrete.