

DR System

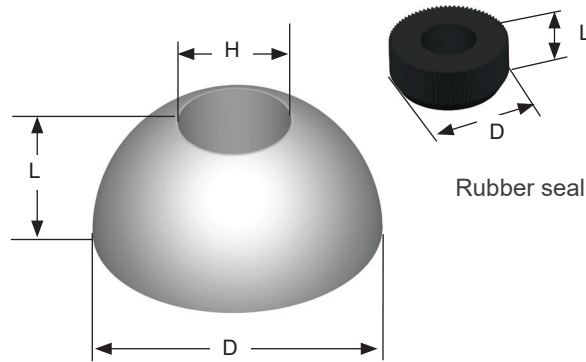

Magnetic Recess Formers

This steel body is turned from solid material and fitted with a high-performance magnetic system, providing a high-powered magnet for locating DR Anchors in steel forms.



| ITEM CODE | SYSTEM CODE | RECESS DIAMETER (D) | RECESS HEIGHT (L) | HOLE DIAMETER (H) | THREAD SIZE |
|-----------|------------------------|---------------------|-------------------|-------------------|-------------|
| KA13M | 1.3 | 2-3/8" | 1-1/8" | 13/16" | M8 |
| KA25M | 2.5 | 2-7/8" | 1-5/16" | 1-1/8" | M12 |
| KA50M | 5 | 3-11/16" | 1-5/8" | 1-1/2" | M12 |
| KA75M | 10 | 4-3/4" | 2-1/8" | 1-7/8" | M12 |
| | | | HEIGHT (L) | DIAMETER (D) | |
| KA13GM | Rubber Seal For Magnet | | 7/16" | 13/16" | |
| KA25GM | Rubber Seal For Magnet | | 1/2" | 1-3/16" | |
| KA50GM | Rubber Seal For Magnet | | 9/16" | 1-1/2" | |
| KA75GM | Rubber Seal For Magnet | | 3-4" | 1-15/16" | |

Rubber Recess Formers

Used to Recess DR Anchors relative to the concrete surface. Each Rubber Recess Former requires one Wing Nut, Plate, and Stud Set to attach it to the form.

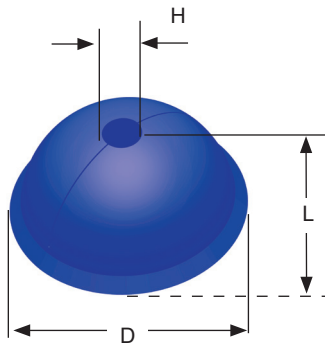

| ITEM CODE | SYSTEM CODE | RECESS DIAMETER (D) | RECESS HEIGHT (L) | HOLE DIA. (H) |
|-----------|-------------|---------------------|-------------------|---------------|
| DRR01 | 1.3 | 2-5/16" | 1-3/16" | 3/8" |
| DRR02 | 2.5 | 2-7/8" | 1-7/16" | 9/16" |
| DRR04 | 5 | 3-11/16" | 1-7/8" | 3/4" |
| DRR08 | 10 | 4-5/8" | 2-5/16" | 1-1/8" |
| DRR16 | 20 | 6-1/2" | 3" | 1-1/2" |

Steel Recess Former

Drilled and tapped to allow bolting directly to the form. Can be welded to certain types of forms where location is permanent.

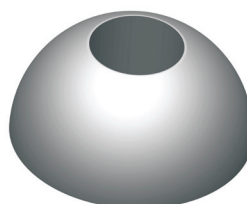

| ITEM CODE | SYSTEM CODE | RECESS DIAM. X DEPTH |
|-----------|-------------|----------------------|
| DRS01 | 1.3 | 2-5/16" X 1-3/16" |