

## Magnetic System for Steel Formwork

### KA Series

The KA Series magnet is machined from solid material and fitted with high performance magnets, providing a high power system for securing DR Anchors. The magnetic surface is sealed, protecting it against corrosion and damages.

Requires use of rubber seals to stabilize anchor (see DR Anchor).

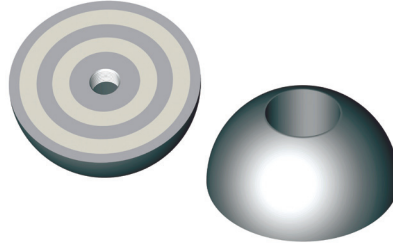

ITEM CODE	LOAD	DIMENSIONS
KA-13M	1 TON	2-3/8"
KA-25M	2 TON	3"
KA-50M	4 TON	3-7/8"
KA-75M	8 TON	4-3/4"

### Magnetic Locator

Use for fixing coil or Ferrule inserts to steel forms.

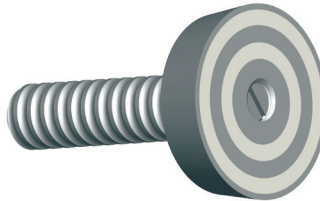

ITEM CODE	DIAMETER	THREAD TYPE
MLC05	1/2"	Coil
MLC75	3/4"	Coil
MLC10	1"	Coil
MLN05	1/2"	NC
MLN75	3/4"	NC
MLN10	1"	NC

Custom cut rod length.

### R/Z Series

The R/Z – Series magnetic system was specifically designed to be fitted into reusable box-outs. Compared to other systems of its kind, the R/Z series is specially sealed to protect its magnetic side. This system is characterized by particularly high magnetic force.

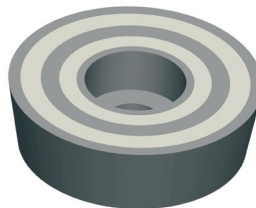

ITEM CODE	TENSION LOAD IN (LBS)	WIDTH	HEIGHT
R/Z-105	231	2"	9/16"

### R/G Series

The R/G Magnetic system is designed to help with installing attachments to steel forms without drilling or bolting. Due to its high adhesion power and slender design, this magnet holds attachments on flat and vertical surfaces with confidence while taking up minimal space. These magnets come standard with metric threads from 10mm through 36mm. Standard NC thread combinations are also available.

ITEM CODE	TENSION LOAD IN (LBS)	DIAMETER	HEIGHT	THREAD
R/G-105	231	2-1/16"	9/16"	10mm-36mm
R/G-190	418	2-1/16"	9/16"	10mm-36mm

